

EGT 355: Cable-type temperature detector with immersion stem

For universal, direct installation without protective tube. For direct connection in systems with short distances between controller and detector.

Nickel sensor as per DIN 43760, cast in stainless-steel immersion tube of Ø 6.5 mm, active length 20 mm; with vulcanised silicon connection cable of Ø 9 mm, 1.5 m long; wires 2 × 0.5 mm².

Type	Nominal value at 0 °C	Measuring range [°C]	Length of stem [mm]	Weight [kg]
EGT 355 F101	1000 Ω	-30...130	300	0.1
EGT 355 F900	1000 Ω	-30...130	90	0.1
EGT 355 F901	1000 Ω	-30...130	160	0.1

Resistance values as per Tolerance at 0 °C	DIN 43760 ± 0.4 K	Time charact. in water still	Dead time 0.5 s	Time const. 12 s
Mean temp. coefficient	0.00618 K ⁻¹	flowing (0.4 m/s)	0.4 s	9 s
Self-warming (in air)	0.14 K/mW	Degree of protection	IP 42 (EN 60529)	
Resistance to compression	PN 16	Wiring diagram	A01632	
Time characteristic in air	Dead time still 5 s moving (3 m/s) 2 s	Time const. 300 s 60 s	Dimension drawing	M02130
		Fitting instructions	MV 8268	



T03393

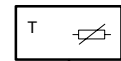

Y01875

Accessories

0312134 000* Brass screw fitting R ¼ (ISO 7/l) for immersion

0312135 000* Stainless-steel screw fitting R ¼ (ISO 7/l) for immersion (DIN material no. 1.4401)

*) Dimension drawing or wiring diagram are available under the same number

Operation

The resistance value of the Ni measuring resistor changes with respect to temperature. The temperature coefficient is always positive, i.e. the resistance value increases as the temperature rises. See table of values (DIN 43760). The elements are exchangeable (within the limits of the prescribed tolerances).

Engineering and fitting notes

The connecting cable of silicon is dry-vulcanised and, therefore, produces few emissions; the detectors' components contain no silicon, thus allowing them to be employed in paint shops

Additional technical data

Complies with:-	
EMC directive 89/336/EEC	EN 61000-6-1/ EN 61000-6-2 EN 61000-6-3/ EN 61000-6-4

Wiring diagram

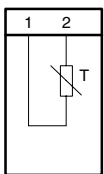

A01632

Dimension drawing

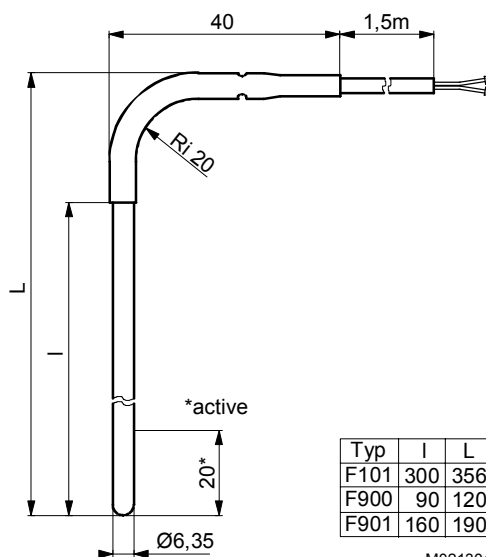

Typ	l	L
F101	300	356
F900	90	120
F901	160	190

M02130a

Accessories

312134
312135

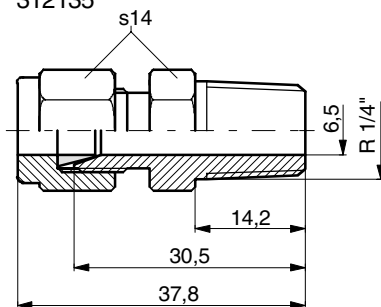

M00853